

# TM50 Touch User Guide - Digiplex EVO Systems

DIGIPLEX  
EVO



**CRIMEWATCH**  
SECURITY  
**1300 928 241**

P ▲ R ▲ D O X™



# Main Screen

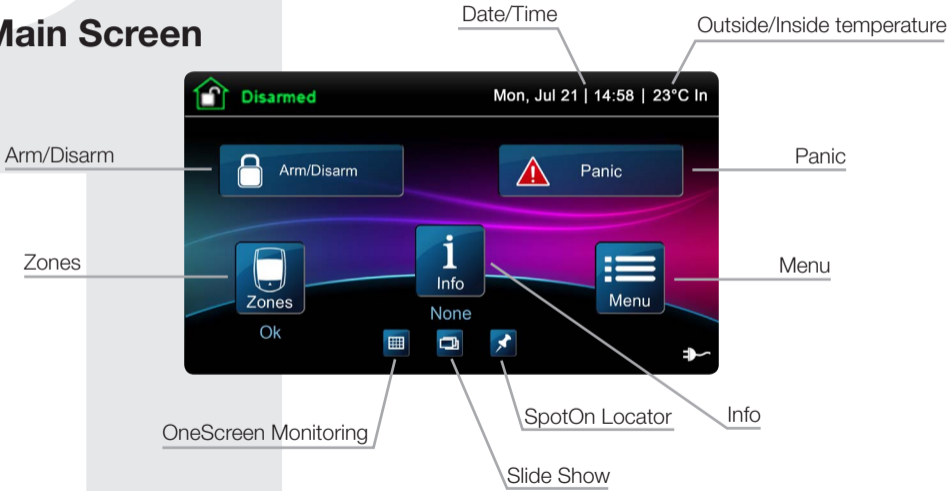

## Arming/Disarming your System

### Arming/Disarming your system:

1. Press **Arm/Disarm** button from main screen.
2. Select Arming method.
3. Enter code (4 to 6 digits).



# Menu

For menu options press the Menu button and follow the on-screen prompts. Menu options include:

- Security Functions
- User Codes
- Control Devices
- Add-on
- System Settings
- Personalize
- Advanced

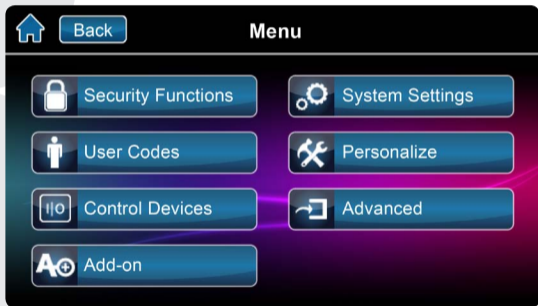

## Entering User programming

Enter user programming:

1. Press **Menu**.
2. Press **User Codes**.
3. Enter Master Code.



## Programming a New User

### Programming a new user:

1. Press the **Add** button to add a user.
2. Modify Label or press **Skip**.
3. Enter new user code and press **Next**.
4. Confirm user code by entering a 2<sup>nd</sup> time then press **Next**.
5. Option to learn remote in, press button on remote or press **Skip**.
6. Enter access card number or press **Skip**.
7. User Settings or press **Done**.
8. User is now valid.

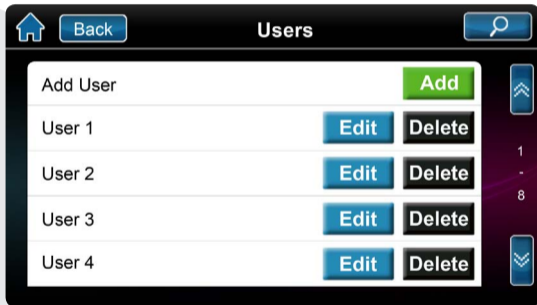

## Settings Screen

Setting screen accessed through Menu then System Settings.  
Settings include:

- Time & Date
- Display Setting
- Clean Screen
- Volume/Mute
- Permissions

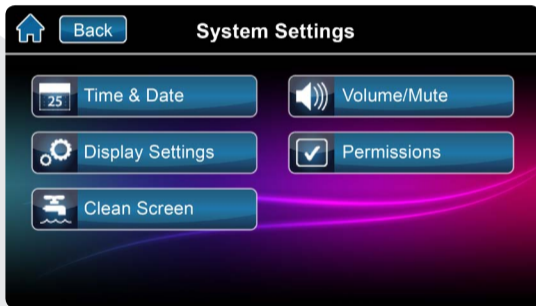



# OneScreen Monitoring™

## To Access OneScreen Monitoring\*:

1. Press the  button.
2. View open/closed zones (an open door means a zone is open).
3. Press on the **Test** button to test all your zones (SoloTest Mode).
4. Press on the **Settings** button (top right corner) to access more options.

\*OneScreen Monitoring is an optional feature.  
Please contact your installer for more information.

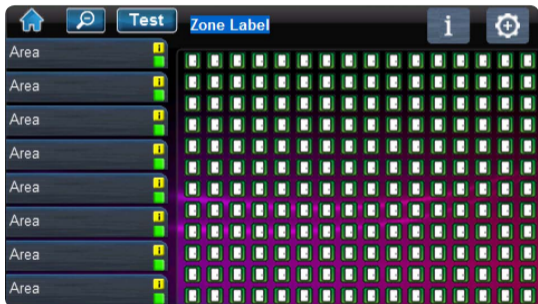

## SpotOnLocator™

### To Access SpotOn Locator\*:

1. Press the  button.
2. Follow the onscreen instructions on how to upload photos, images, or schematics for your personalized floor plans.
3. Follow the onscreen instructions on how to add/move/delete zones from your floor plan.

\*SpotOn Locator is an optional feature. Please contact your installer for more information.



# SlideShow

## To Access SlideShow:

1. Press the  button to view the default slideshow.
2. Press on the **Settings** button (bottom right corner) to access more options.

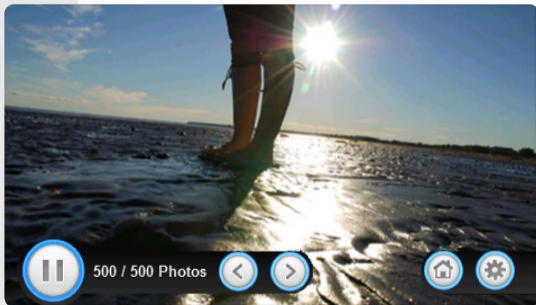

## microSD Card

The TM50's integrated SD card slot has a cover clip for its protection.

If it is foreseen that the microSD card will be used frequently, it is best that the microSD card cover clip be removed before installation. This is because once the keypad is installed, removal of the microSD card requires you to unclip the entire front plate of the TM50.

**To remove/replace the microSD (without cover clip):**

1. Push down on the microSD card to unlock.
2. Gently pull out the microSD card to remove.  
If desired, replace card.

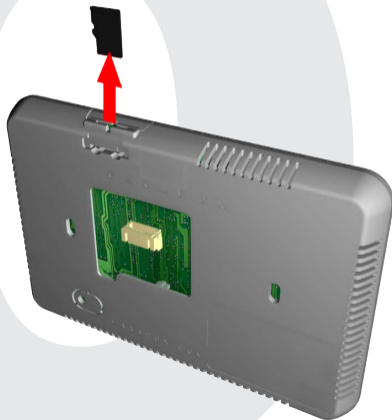

# microSD Card

To remove/replace the microSD card with cover clip:

1. Using a screwdriver, pry the front housing assembly from the backplate. Once removed, you will notice that the microSD cover clip protection is part of the backplate.
2. Remove the microSD card from the front housing assembly. If desired, replace card.

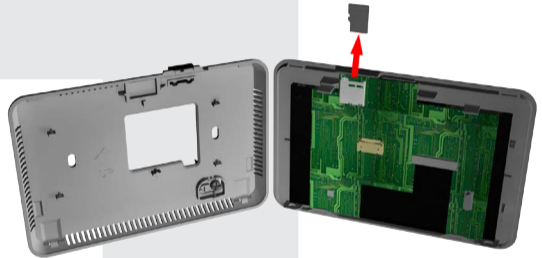



**Warranty:** For complete warranty information on this product, please refer to the Limited Warranty Statement found on the Web site [www.paradox.com/](http://www.paradox.com/) terms. Your use of the Paradox product signifies your acceptance of all warranty terms and conditions. One or more of the following US patents may apply: 7046142, 6215399, 6111256, 6104319, 5920259, 5886632, 5721542, 5287111, and RE39406 and other pending patents may apply. Canadian and international patents may also apply. © 2013 Paradox Ltd. All rights reserved. Specifications may change without prior notice. [www.paradox.com](http://www.paradox.com)

**CRIMEWATCH**  
**SECURITY**  
**1300 928 241**

**P ▲ R ▲ D O X™**  
PARADOX.COM

TM50E-EU01  
Printed in Canada 02/2013